

3443 HANCOCK BRIDGE PARKWAY
NORTH FORT MYERS, FL

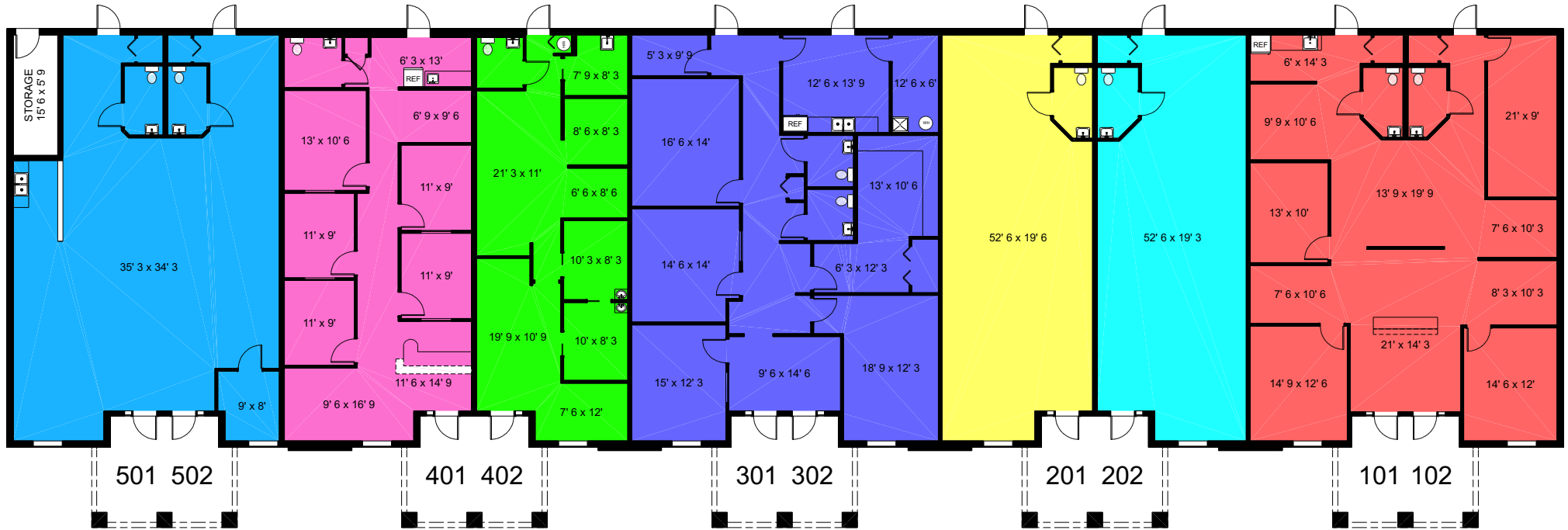

STORAGE AREA 123 sq. ft.
TOTAL BUILDING AREA 10569 sq. ft.

SUITES 101 & 102	2142 sq. ft.
SUITE 202	1041 sq. ft.
SUITE 201	1050 sq. ft.
SUITES 301 & 302	2108 sq. ft.
SUITE 402	1057 sq. ft.
SUITE 401	1312 sq. ft.
SUITES 501 & 502	1737 sq. ft.

TOTAL USABLE AREA 10447 sq. ft.

Prepared exclusively for Ken Saundry.
©2020 Precision Floorplans, Inc. This document is the copyright property of Precision Floorplans, Inc.
Any other user may not copy, modify, reproduce, republish, distribute, display, or transmit for commercial, nonprofit or public purposes all or any portion of this document except to the extent authorized by Precision Floorplans, Inc. (239) 598-9411 precisionfloorplans@earthlink.net
Copyright infringement (Title 17 Chapter 5 Section 501) in the U.S. Federal Court.
ALL INFORMATION IS DEEMED RELIABLE NOT GUARANTEED

This floor plan is created from field measurements. The area calculations for usable area are based upon measurements from outside exterior walls to the center of demising walls and inside common area walls.