

FINAL ASBUILTS

DRAWN B.D.J.	
DATE 2/25/03	
CHECKED J.P.T.	
REVISIONS	
DATE	BY

**A NEW BUILDING FOR
 HITCH & TRAILERS
 OF FORT MYERS, INC.**
 LEE COUNTY, FLORIDA

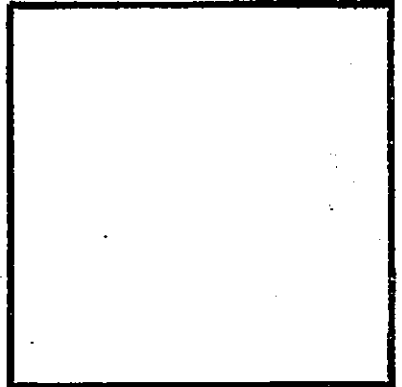

JASON P. TRAMONTE
 A R C H I T E C T
 I N C.
 4524 SE. 16TH PLACE CAPE CORAL, FLORIDA 33904
 (239) 549-0997 AA 0002443

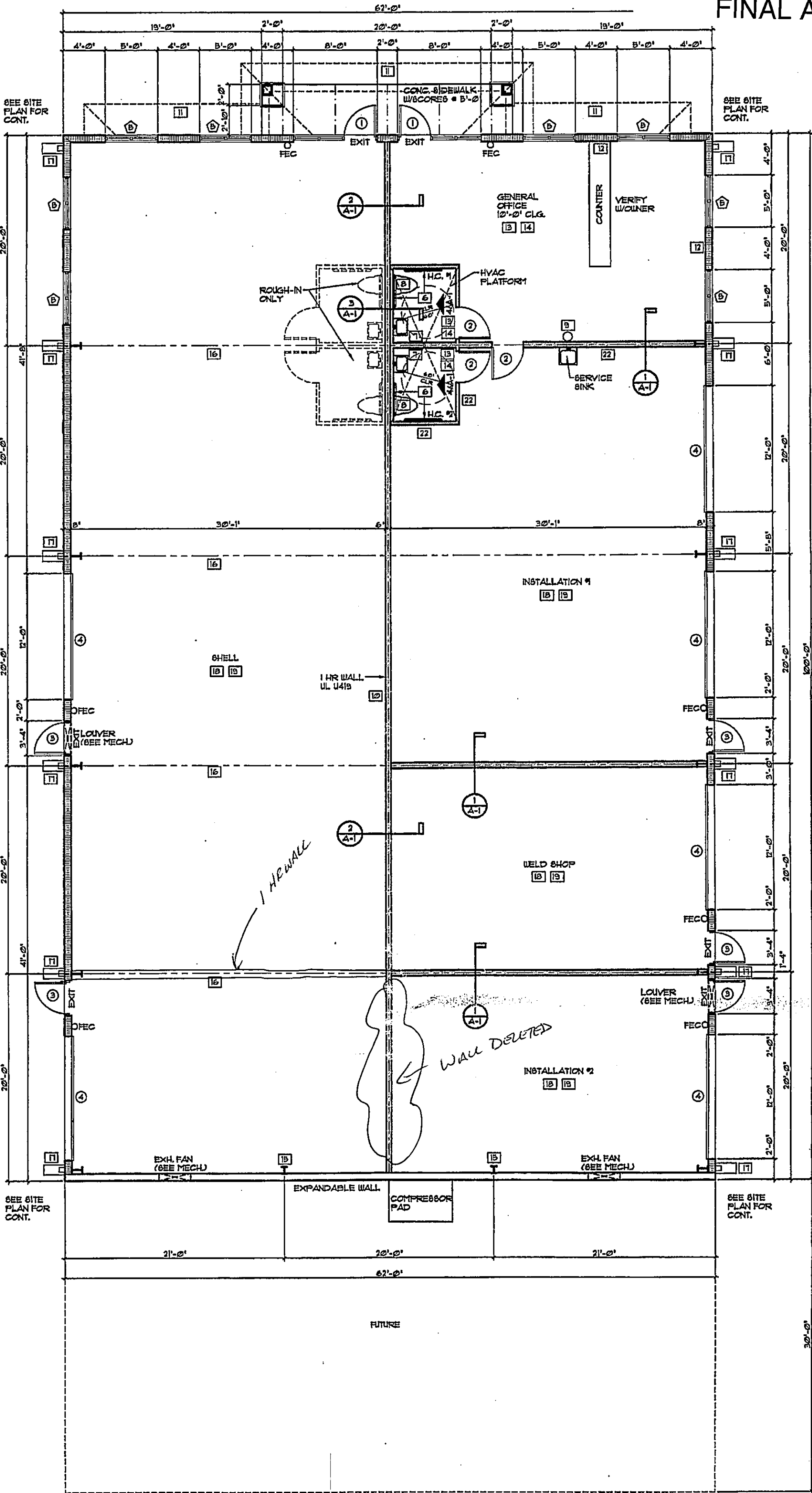

FLOOR PLAN

LEGEND:

- 8" CMU MASONRY WALL HEIGHT AS SHOWN ON ELEVATIONS
- 3-5/8" OR 6" METAL STUDS @ 16" O.C. W/ 1/2" GYP. BOARD ON EACH SIDE & VINYL BASE.
- (1) LAYER OF 5/8" TYPE "X" GYP. BOARD ON EACH SIDE OF 6" 18GA. METAL STUDS @ 24" O.C. UL U419. VINYL BASE, TYP. R-11 BATT INSULATION
- INDICATES (1) 2A 10BC FIRE EXTINGUISHER ON HOOK

SCALE: 1/8" = 1'-0"

NOTES TO PLANS EXAMINER

THIS PROJECT IS A 6200 SQUARE FOOT TYPE IV, UNSPRINKLED, SINGLE STORY, STORAGE OCCUPANCY.